

F_Electra



Fedesa

F_Index



Fedesa

Since 1970, two family generations and a large professional team have devoted all their passion and knowledge towards creating the best experience in dental care for dentists and their patients.

We design and manufacture high performance dental units in Spain, in which every component has been developed to be comfortable, efficient and long-lasting.

1_About us

1.1_Insights

1.2_Claim

1.3_Reasons to believe

2_F_Electra

2.1_Premium

2.2_Lux

2.3_Eco

2.4_Orthodontics

3_Finishes

3.1_Textile Colour

3.2_Upholstery

3.3_Measures

3.4_Illumination Lamp

3.5_Monitor

3.6_Control Pedals

3.7_Mobile Units

3.8_Stools

4_Fedesa

4.1_History



Fedesa

Your essential teammate, always by your side

FEDESA is a dentist's essential teammate - equipment you can rely on for doing your job and a team that shares the same passion for dental health.

A dental chair always goes alongside a dentist. It's their best ally for inspiring trust and peace of mind in patients.

At FEDESA, we are part of your team, and we are always at your side so that nothing gets in the way of your patients' treatment.

Fedesa

High performance, maximum reliability

FEDESA has been the market leader in high performance dental units in Spain for over 50 years.

With our experience in design, processes and manufacturing technology, we are able to make high performance equipment accessible to all kinds of clinics.

All our work is focussed on offering you the best experience, service and durability.

Dentist take centre stage and are the core of all that we do. They have a very evident vocation that defines them as individuals.

This vocation is shared by the whole FEDESA team. A family united by a passion to help professionals in the dental sector.



A great, leading company that casts its legacy towards the future

FEDESA has been the undisputed leader of the Spanish market for decades. As well as leading in terms of market share, we are a great company because of our history and the strength of our human resources.

We do not settle for what has already been done. Rather, we look towards the future with an ambition for continual improvement, innovation and sustainability.



High performance dental units for the most discerning professionals

The most discerning dentists choose FEDESA because our high performance dental units are designed and manufactured to be the essential teammate that makes your job easier for many years to come.

We guarantee the performance and durability of our units as a result of our rigorous production processes, quality control and external certifications.



A committed, passionate team that is always there for dentists

The FEDESA team shares the same values that it has transmitted from generation to generation.

All our work aims to make a dentist's job easier.



For the most discerning professionals

We design and manufacture high performance dental units in Spain, in which every component has been developed to be comfortable, efficient and long-lasting.

60.000
units used by
dentists from 79
countries.

15 years
Useful life of

3.200
models in stock for
48-hour dispatch to
anywhere in Europe

10.000m²
production and
development centre
in Madrid measuring

Dentists treat patients with serious oral health problems. They need to diagnose, treat and follow up with patients until they have recovered.

Dentists also conduct preventative treatments to ensure their patients' oral health.

Just like their patients, dentists need quick responses and the ability to react in adverse circumstances.

We conduct maintenance and follow-up to ensure maximum performance for your equipment.

FEDESA is a dentist's essential teammate, always at their side, sharing the same passion for oral health.

F_Electra

¿What is the Electra model?

e

With this new dental unit Electra, we have developed a new way to work in which join ergonomics, functionality, design, versatility, technological innovation and major interaction between operator-patient. It's important that patient feels comfortable, serene and relaxed when operator starts the treatment.

For this reason, Electra dental unit presents a chair which makes the contact, communication and dialogue between operator and patient "face to face" favoring an operative conditions more comfortable for them.



Electra dental unit presents important details that helps operator in his daily working reducing fatigue, saving movements and adapting the unit to the different positions that patient treatment requires.

Electra dental unit includes three configurations: PREMIUM, LUX and ECO which, together with the ORTHODONTICS version, can cater for a broad spectrum of users based on their various needs thanks to their user-friendliness and versatility, as well as the reliability of their equipment.

F_Electra



Electra Premium

The unit incorporates in its basic configuration the following equipment: an independent control panel for the dental unit and for the control of the micromotor and scaler, LED light on all the instruments, endo induction micromotor, ultrasonic scaler with LED light and a LED type illumination lamp

Page 14-15



Electra Lux

The **Electra Lux model**, with the same formal and functional features as the PREMIUM range, provides the most standard configuration.

incorporates multi-purpose hoses with light, an electric brushless or induction micromotor with light and ultrasonic scaler.

Page 16-21



Electra Eco

The **Electra Eco model**, represents the basic configuration of the model.

Is a pneumatic unit with the cuspidor and tray attached to the structure of the chair. It includes a foot pedal to control the speed of the instruments, water selector and chip blower.

Page 22-25



Electra Orthodontics

The **Electra dental unit** also offers a special configuration for orthodontic treatments. All the instruments required for these purposes can be added to the assistant's work position.

The unit features a multi-function foot pedal to control the speed of the instruments, as well as the independent movement of the chair.

Page 26-27

F_Electra

premium

Electra Premium



The unit incorporates in its basic configuration the following equipment: an independent control panel for the dental unit and for the control of the micromotor and scaler, LED light on all the instruments, endo induction micromotor, ultrasonic scaler with LED light and a LED type illumination lamp.



Control Panel

All the functions of the dental unit are controlled in an easy and intuitive way. Equally, the parameters of the micromotor (speed, torque, light, direction of rotation, etc.) are also displayed and controlled, as well as those of the ultrasonic scaler (functions: general, endo and perio).

Available with whip/continental type main instrument tray, with hanging hoses and a mobile unit.

F_Electra lux

Electra Lux



The Electra Lux model, with the same formal and functional features as the PREMIUM range, provides the most standard configuration. As in the rest of the Electra range, the unit's safety systems ensure incident-free use. Safety system applied to the chair lowering function, to the backrest and to the assistant's workstation.



Chair movements

Special mention to dental chair movements: seat is knee turn system. Its movement is synchronized with backrest and footrest. This system makes easy communication between patient and operator and favors access of the patient to chair.

The Lux version, as in the rest of the range, can be configured as a hanging version or a mobile unit version.

F_Electra lux

Its user-friendliness, versatility and the reliability of the equipment allow for easy and affordable maintenance. The Electra Lux model incorporates multi-purpose hoses with light, an electric brushless or induction micromotor with light and ultrasonic scaler.



Doctor tray

Includes an instruments holder which can be removed to make easy its cleaning and disinfection.

F_Electra

lux



Water Bowl

Can spin 180° for the benefit of the assistant, making it easier for patients to rinse their mouths. The bowl and faucet of the water supply system enjoy an excellent level of mobility (with a working radius of + - 90°) to adapt to the various needs of patients.



The assistant's unit includes a tray with four holders on a double-articulated arm that allows the assistant to place the unit in a wide range of positions.



Dental chair

Incorporates in its base a joystick to control movements of chair. Also includes a button to activate return to zero position.

F_Electra

eco

Electra Eco



The Electra ECO model, which has the same formal and functional specifications as the entire range, is slightly less equipped and represents the basic configuration of the model. When simplicity is enough.

The Eco version is a pneumatic unit with the cuspidor and tray attached to the structure of the chair. The assistant's position features a simple tray with two holders (four can be provided on request) and the main tray includes pneumatic instruments with an ultrasonic scaler. It includes a foot pedal to control the speed of the instruments, water selector and chip blower (optionally, you can incorporate a multifunction foot pedal).



Headdrest

Height-adjustable and double articulation headrest. Its ergonomics allow patients to place their heads in the ideal position for the doctor to work.

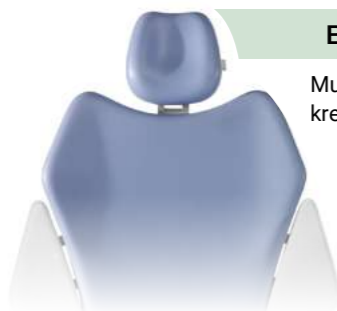

Backrest

Multifunctional and adaptable backrest with and without a cut-out.

F_Electra

eco



Cuspidor

Incorporates faucets and a bowl. The bowl is made of tempered glass and can be removed to facilitate cleaning, thus providing higher levels of hygiene. The colour of the bowl can be combined with the colour of the upholstery.



All versions of the Electra dental unit can be configured in three different ways: whiparm/continental type, with hanging hoses and with a mobile unit.



Instrument tray

Main doctor tray incorporates a rotational movement on itself which offers possibility to locate the tray in the best position for operator. There is also a control panel and an articulated instrument tray.

F_Electra

orthodontic



The Electra dental unit also offers a special configuration for orthodontic treatments. All the instruments required for these purposes can be added to the assistant's work position. The water and air syringe, rotary instruments and the suction hoses are fitted to a tray with four holders.

This version also features an instrument tray that is fitted on a double-articulated arm that provides a wide range of movements. The unit features a multi-function foot pedal to control the speed of the instruments, as well as the independent movement of the chair.

Available in two versions of articulated arms.





Fedesa

We are accessible to all kinds of clinics

Dentists take centre stage and they are at the core of all that we do. All our work is focussed on offering you the best experience, service and durability.

With our experience in design, processes and manufacturing technology, we are able to make high performance equipment accessible to all kinds of clinics.

Choosing FEDESA is a matter of trust.

Finishes

F_Electra

Textile colour finishes that combine with the dental unit

We have selected a wide range of colours for standard use to integrate with modern facilities.



Upholstery

FEDESA provides upholstery on all its dental units that add to the design of its equipment, improving their convenience and comfort.

Low maintenance flame retardant upholstery without seams, washable and excellent resistance to use.

The extensive catalogue of upholstery colours also comes with viscoelastic upholstery (memory foam).

Measures of the dental unit

The measurements indicated on the drawing will help you place your equipment in your surgery.

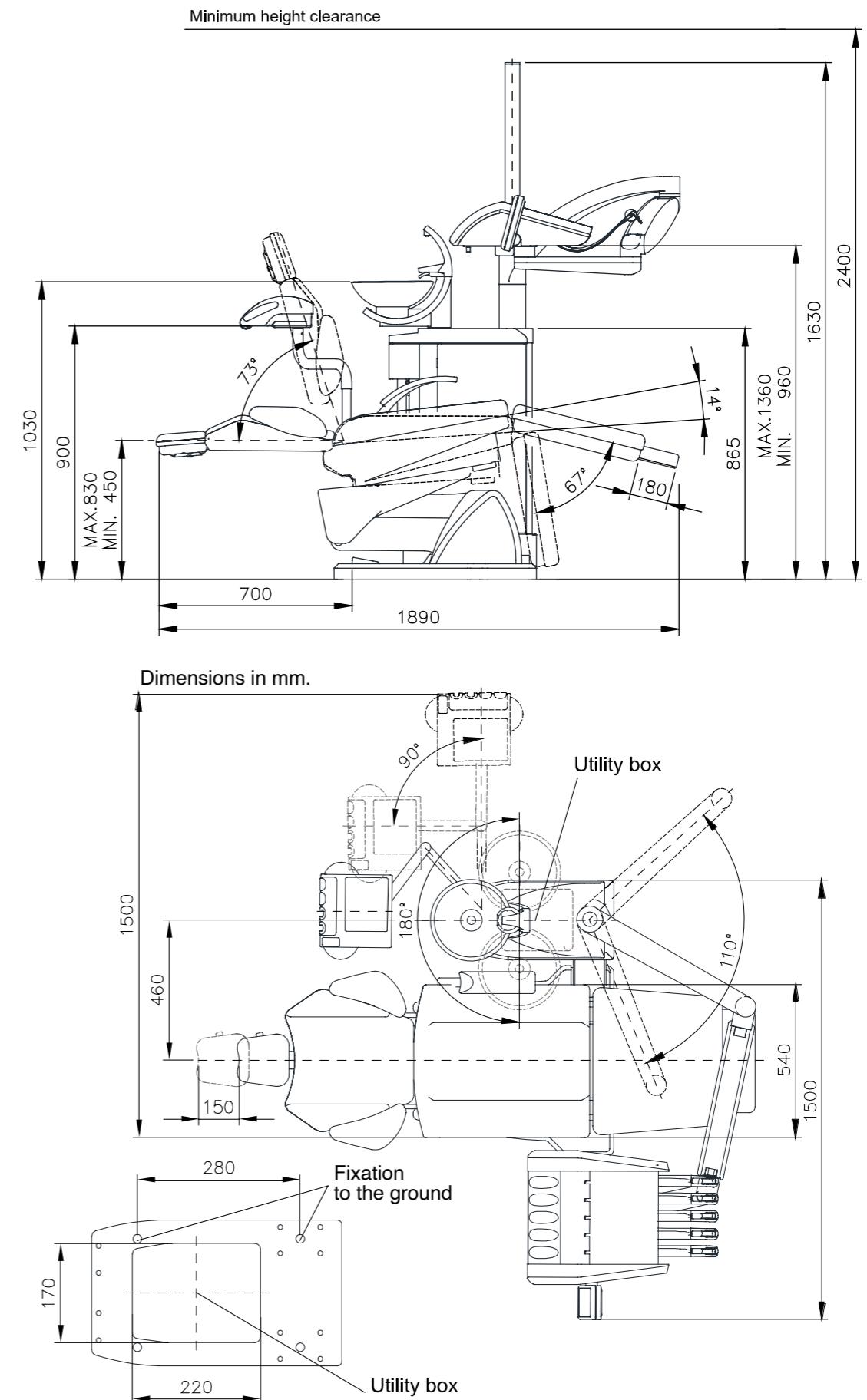

Options

F_Electra

Illumination lamp

All FEDESA dental units include lighting equipment that can be changed as an option.

EDI Lamp (25,000 lux halogen lamp). MAIA Lamp (35,000 lux LED lamp). ALYA Lamp (50,000 lux LED lamp).



Edi model



Maia model



Alya model

Control pedals

There are two types: pneumatic pedals with instrument rpm control, water and chip blower selector, and a multifunction pedal for instrument control and to adjust the chair.



Progressive Pneumatic Model



Multifunction Model



Pneumatic Model

Monitor

Slim, lightweight, with a 17" screen and adaptable to the various positions required for use by the doctor and patient.



Intraoral camera

High-resolution camera that can be added to the main tray and to the auxiliary tray. Small and very light, touch activation and detachable.



Mobile Units

There are various ranges of mobile units: **Premium, Lux** and **Eco**. The Premium range features an induction micromotor integrated into the control panel. The Lux range has an electric brush micromotor and the Eco range features pneumatic instrumentation.



Astral Premium Model



Astral Lux Model



Astral Eco Model

Stools

FEDESA has three types of stools (the **Astral, Pony** and **Sory** models) available with or without backrests and with a footrest ring. Surround lumbar support. They are manufactured in stainless steel and feature a five-wheel base, as well as gas piston height adjustment. A wide range of colours and textures in the upholstery catalogue.



Astral mModel

Astral - A Model



Pony Model with backrest

Pony Model without backrest



Sory Model



Fedesa

United by the same passion

Dentists have a very notable vocation that defines them as people. Their profession is in their very DNA. In their nature is a passion to help and to treat patients.

This vocation is shared by the whole FEDESA team. A family united by the passion to help professionals in the dental sector.



Manufacturing dental units since 1970

From the origins of **FEDESA** back in the 1970s and right up to the present day, we have dedicated our efforts to meet the needs of dentists.

We are experts in designing, manufacturing, and marketing dental units. Our extensive catalogue of solutions caters for all the needs of today's dentists.

Our products meet all national and international regulations and certifications that ensure the quality of all our products. A wide network of agents approved by our brand for the domestic market, as in the rest of the world, collaborate with us to offer the best customer service.



FEDESA is a global company with an unbeatable history in quality, technology and service.

It has an extensive network of distributors all over the world and an excellent professional team that is committed to the company.



Fedesa

NUEVA FEDESA, S.A.

Avda. Madrid, nº 45. 28500 Arganda del Rey (Madrid) España
Tel.: 34 - 91 871 23 83. Fax: 34 - 91 871 64 88
fedesa@fedesa.com - www.fedesa.com

FEDESA se reserva el derecho de introducir cualquier cambio en beneficio del producto
CT9A23-1I. (1000 EJ. 20-03-019)
Diseño: De Ledesma. Imprime: Gráficas Aries. Depósito legal: M-7XXXXX

Fedesa

High performance, maximum reliability